



THE TOWNSHIP OF UPPER

2100 Tuckahoe Road, Petersburg, NJ 08270
PO Box 205, Tuckahoe, NJ 08250-0205

PAUL E. DIETRICH, SR., P.E., P.P.

Township Engineer

Floodplain Manager

Municipal Housing Liaison - Computer Director

Phone: 609-628-2011 Ext. 244

Cell: 609-425-2867

Fax: 609-628-3092

E-mail: engineer@uppertownship.com

Reconstruction of Commonwealth Ave

Project Limits: North of Willard Ave to North of Winthrop Ave, Strathmere

Project Estimate: \$305,000

Anticipated Construction: Spring or Fall 2019

Project is funded with a grant from the NJDOT and Municipal Bond.

Project will reconstruct the roadway, drainage infrastructure, replace curb & sidewalk as necessary and provide crosswalks.

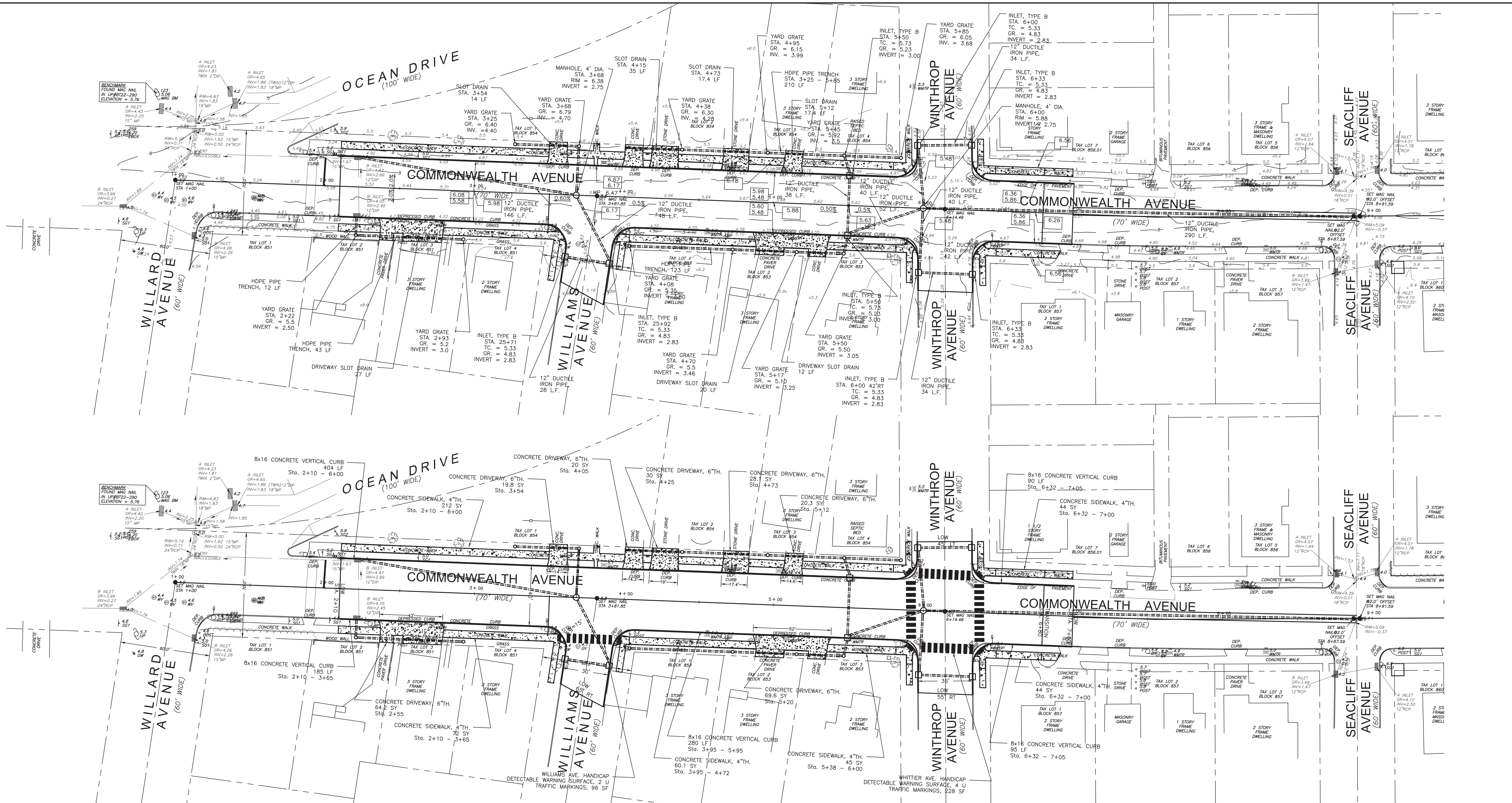

ITEM NO.	ESTIMATED DISTRIBUTION OF QUANTITIES	UNIT	PLAN QUANTITY	WHERE DIRECTED
6	PREPARATION OF ROAD BASE	S.Y.	2603	—
7	EXCAVATION, UNCLASSIFIED	C.Y.	—	50
8	BORROW EXCAVATION	C.Y.	—	100
9	DENSE GRADED AGGREGATE BASE COURSE, 6" THICK	S.Y.	2603	47
10	HOT MIX ASPHALT (HMA) 19L64, 3 1/2" THICK	TON	524	26
11	HOT MIX ASPHALT (HMA) 9.5L64 1 1/2" THICK	TON	224	26
12	INLET, TYPE B	EA	5	—
13	YARD GRATE	EA	12	—
14	SLOT DRAIN	EA	142.8	7.2
15	MANHOLE, 5' DIA.	EA	2	—
16	12" DUCTILE IRON PIPE	LF	752	8
17	12" HOPE TRENCH	LF	376	24
18	RESET WATER/GAS VALVE	EA	5	—
19	8"x16" CONCRETE VERTICAL CURB	LF	1054	46
20	CONCRETE SIDEWALK, 4" TH.	SY	477.1	22.9
21	CONCRETE DRIVEWAY, 6" TH.	SY	252	18
22	DETECTABLE WARNING SURFACE	EA	6	—
23	TRAFFIC MARKINGS	SF	324	—
24	TOPSOILING	SY	650	—
25	FERTILIZING & SEEDING, TYPE A-3	SY	650	—
26	FIBER MULCHING	SY	650	—

THE FOLLOWING WORK SHALL BE PERFORMED UNDER CLEARING SITE:
1. REMOVE EXISTING STREET SIGNS AND RESET
2. RESET CONCRETE PAVEMENT DRIVEWAY STA. 5+00 RT.

Benchmark:
BM: MAG NAIL IN UP #BT22-290, STA. 0+85 56' LT, ELEV. 5.76
BM: MAG NAIL IN UP #03578, STA. 11+64 22' RT, ELEV. 5.79

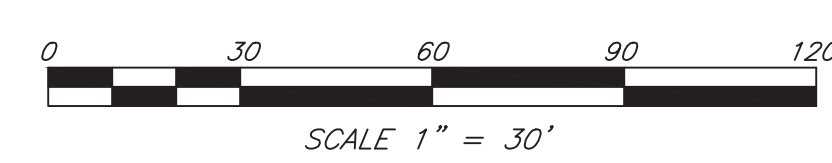

LEGEND

CONCRETE

BRICK PAVERS

VEGETATION LINE

PAVEMENT SEAM

SANITARY LINE

GAS LINE

WATER LINE

FENCE

OVERHEAD WIRE

FIRE HYDRANT

TREE

SANITARY MANHOLE

BUSH/SHRUB

REGULATORY/STREET SIGN

UTILITY POLE

WATER VALVE

GAS VALVE

WATER METER

SEWER CLEANOUT

MAIL BOX

SEWER VENT

STORM INLET

UTILITY POLE w/STREET LIGHT

GUY WIRE

GUY POLE

DATE

REVISIONS

PREPARED BY :

PAUL E. DIETRICH, SR.

PROFESSIONAL ENGINEER

N.J.P.E. LICENSE NO. 41738

UPPER TOWNSHIP ENGINEER'S OFFICE
2100 TUCKAHOE ROAD, P.O. BOX 205
TUCKAHOE, N.J. 08250-0205
609-628-2011 FAX 609-628-3092
email: engineer@uppertownship.com

RECONSTRUCTION
OF COMMONWEALTH AVE. PH1
STRATHMERE SECTION
TOWNSHIP OF UPPER, CAPE MAY COUNTY, NJ

DRAWN: PED

CHECKED:

DATE: 12/13/18

SCALE: 1"=30'

SHEET 2 OF 3

DWG. NO.: 1032