

REVISIONS				
DATE	BY	LIC.NO	BLOCK	LOT

\* THIS SHEET HAS BEEN DRAWN USING COMPUTER AIDED DRAFTING/ DESIGN (CAD/D) AND COORDINATE GEOMETRY (COGO).

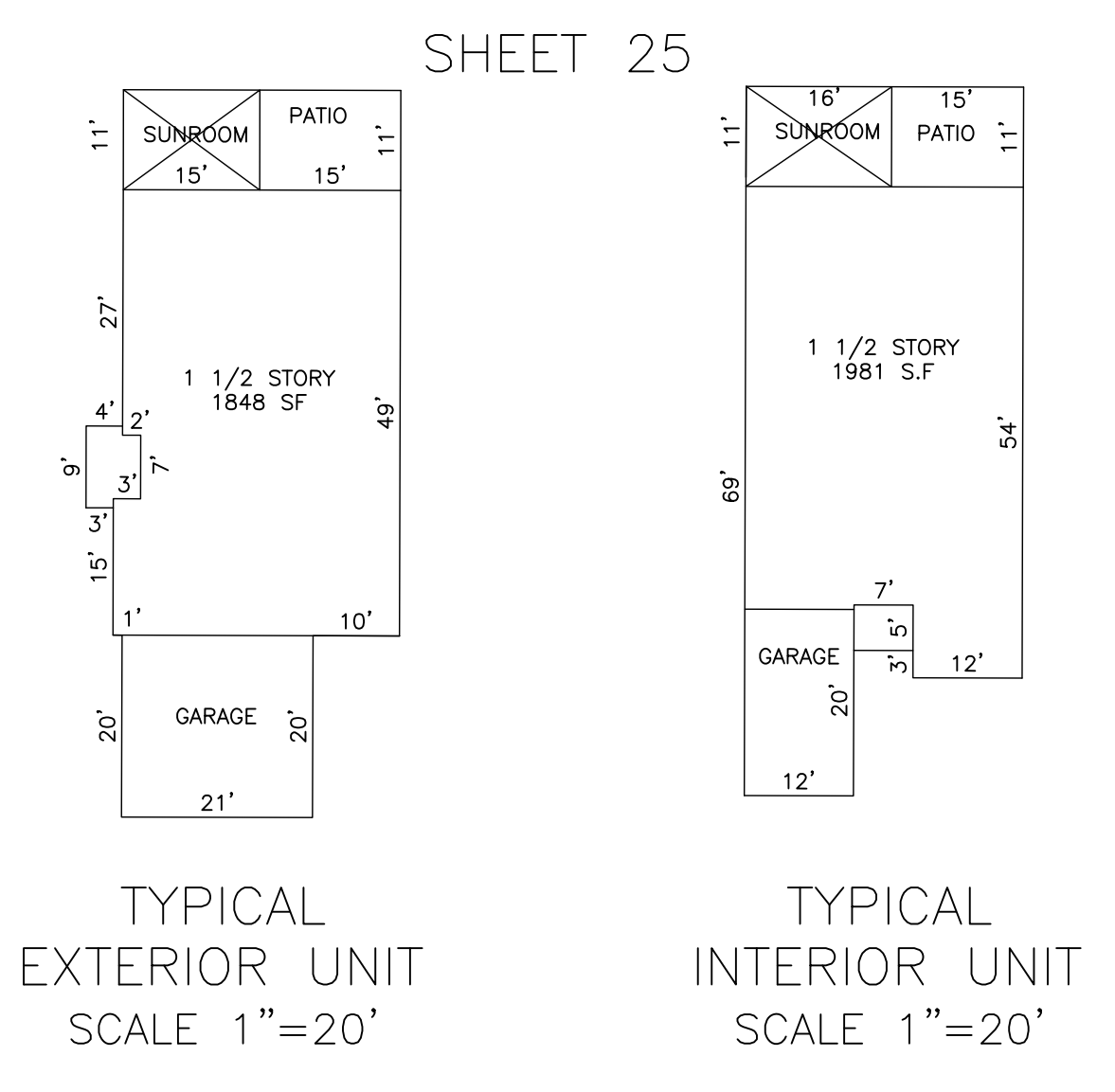

SHEET 25



BLOCK 567 LOT 27							
QUAL	SQ. FT.	QUAL	SQ. FT.	QUAL	SQ. FT.	QUAL	SQ. FT.
C001	1848	C039	1848	C077	1848	C115	1848
C002	1981	C040	1981	C078	1848	C116	1848
C003	1981	C041	1981	C079	1981	C117	1981
C004	1848	C042	1848	C080	1981	C118	1981
C005	1848	C043	1848	C081	1848	C119	1848
C006	1848	C044	1981	C082	1848	C120	1848
C007	1848	C045	1981	C083	1981	C121	1981
C008	1981	C046	1848	C084	1981	C122	1981
C009	1981	C047	1848	C085	1981	C123	1981
C010	1848	C048	1981	C086	1981	C124	1981
C011	1848	C049	1981	C087	1848	C125	1824
C012	1981	C050	1981	C088	1848	C126	1776
C013	1981	C051	1981	C089	1981	C127	1981
C014	1848	C052	1848	C090	1981	C128	1981
C015	1848	C053	1848	C091	1848	C129	1776
C016	1981	C054	1981	C092	1848	C130	1776
C017	1981	C055	1981	C093	1981	C131	1981
C018	1981	C056	1848	C094	1981	C132	1981
C019	1981	C057	1848	C095	1848	C133	1981
C020	1848	C058	1981	C096	1848	C134	1981
C021	1848	C059	1981	C097	1981	C135	1848
C022	1981	C060	1981	C098	1981	C136	1776
C023	1981	C061	1848	C099	1981	C137	1981
C024	1981	C062	1848	C100	1981	C138	1981
C025	1981	C063	1981	C101	1848	C139	1776
C026	1848	C064	1981	C102	1848	C140	1776
C027	1848	C065	1848	C103	1981	C141	1981
C028	1981	C066	1848	C104	1981	C142	1981
C029	1981	C067	1848	C105	1848	C143	1776
C030	1848	C068	1848	C106	1848	C144	1981
C031	1848	C069	1981	C107	1981	C145	1981
C032	1981	C070	1981	C108	1981	C146	1981
C033	1981	C071	1848	C109	1981	C147	1981
C034	1848	C072	1848	C110	1981	C148	1981
C035	1848	C073	1981	C111	1848	C149	1776
C036	1981	C074	1981	C112	1848		
C037	1818	C075	1981	C113	1981		
C038	1848	C076	1981	C114	1981		

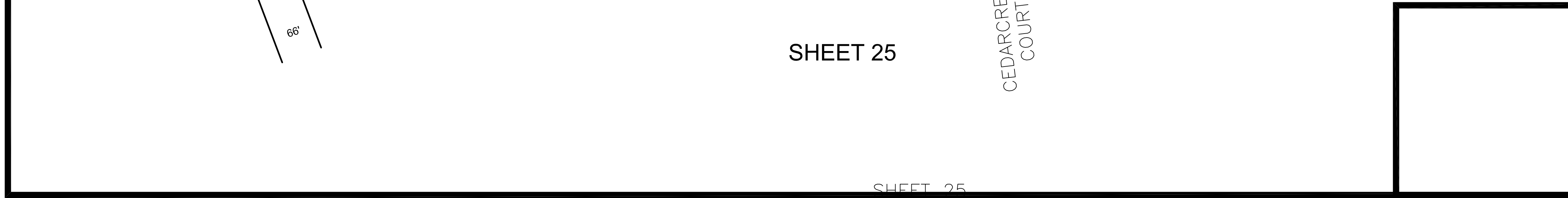

**TAX MAP  
TOWNSHIP OF UPPER**

CAPE MAY COUNTY NEW JERSEY  
SCALE: 1" = 100' DATE: JULY 2016

**ED CLAY**  
LICENSED LAND SURVEYOR  
NEW JERSEY LICENSE NO. 34842  
850 SO. WHITE HORSE PIKE  
HAMMINGTON, NEW JERSEY 08037  
COAP 24GA2797300

TO SHOW CONDITIONS AS OF JULY 2016